

BILL OF MATERIALS

ITEM	QTY.	U/M	PACKING	ISP	INT	DESCRIPTION
1	1	EA				DOWNPIPE SECTION
2	1	EA				CAT SECTION
3	2	EA				CLAMP - 3" BAND
4	1	EA				ADAPTOR
5	1	EA				CLAMP - SPECIAL
6	1	EA				HANGER
7	1	EA				BOLT 3/8-16 x 3/4
8	1	EA				NUT 3/8-16 STOVER LOCK
9	1	EA				D2 EXTENSION WIRE

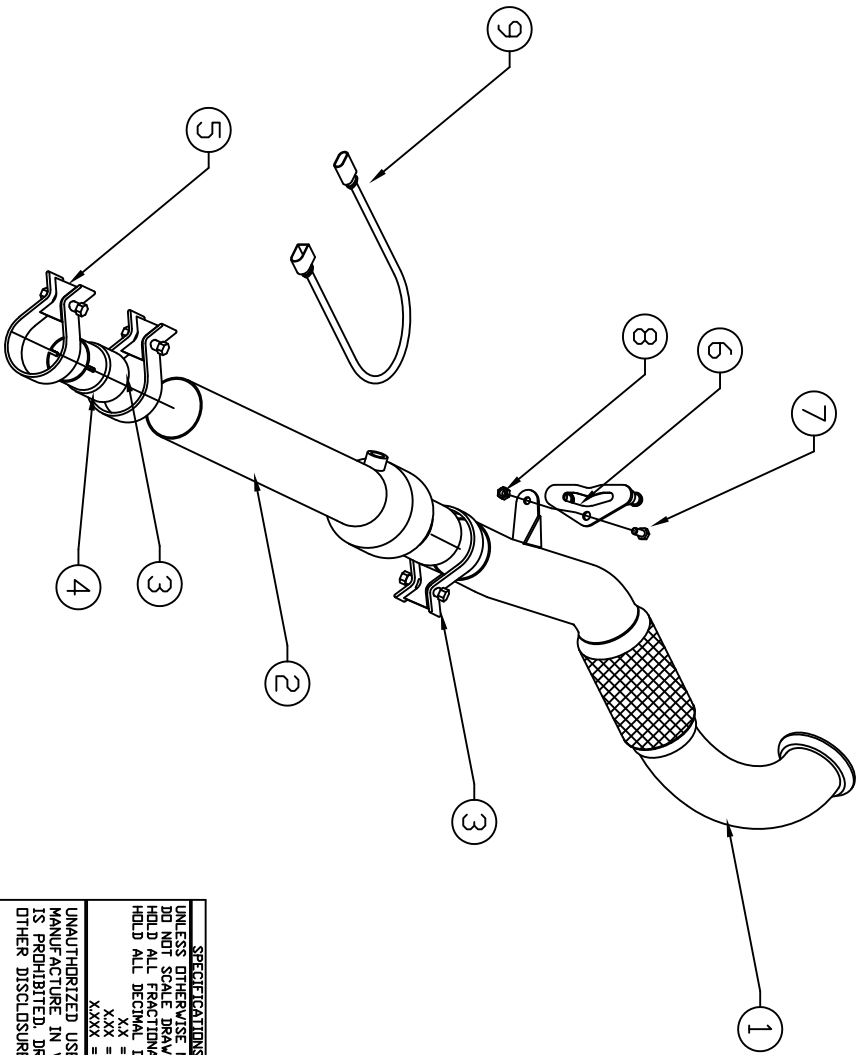

SPECIFICATIONS OF TOLERANCES:

UNLESS OTHERWISE NOTED:  
 DO NOT SCALE DRAWING  
 HOLD ALL FRACTIONAL DIMENSIONS TO  $\pm 1/16$   
 HOLD ALL DECIMAL DIMENSIONS TO:  
 .XX =  $\pm 0.050$   
 .XXX =  $\pm 0.030$   
 .XXXX =  $\pm 0.010$

UNAUTHORIZED USE, REPRODUCTION OR  
 MANUFACTURE IN WHOLE OR IN PART  
 IS PROHIBITED. DRAWING, DESIGN AND  
 OTHER DISCLOSURES ARE PROPERTY OF

DEBURR ALL SHARP EDGES | REV. | DATE | ECN. NO. | BY

A3 QUATTRO DOWNPIPE 2015-

SCALE: INCHES

DATE: 8-30-16

APPROVAL DATE:

**Billy Boat Performance Exhaust**

UNIT(S) INCH

JOB NUMBER: DRAWING NO. FPI0465