

BILL OF MATERIALS

ITEM	QTY.	U/M	PACKING	ISP	INT	DESCRIPTION
1	1	EA				DRIVER SIDE CAT PIPE
2	1	EA				PASSENGER SIDE CAT PIPE
3	2	EA				GASKET
4						
5						
6						
7						
8						

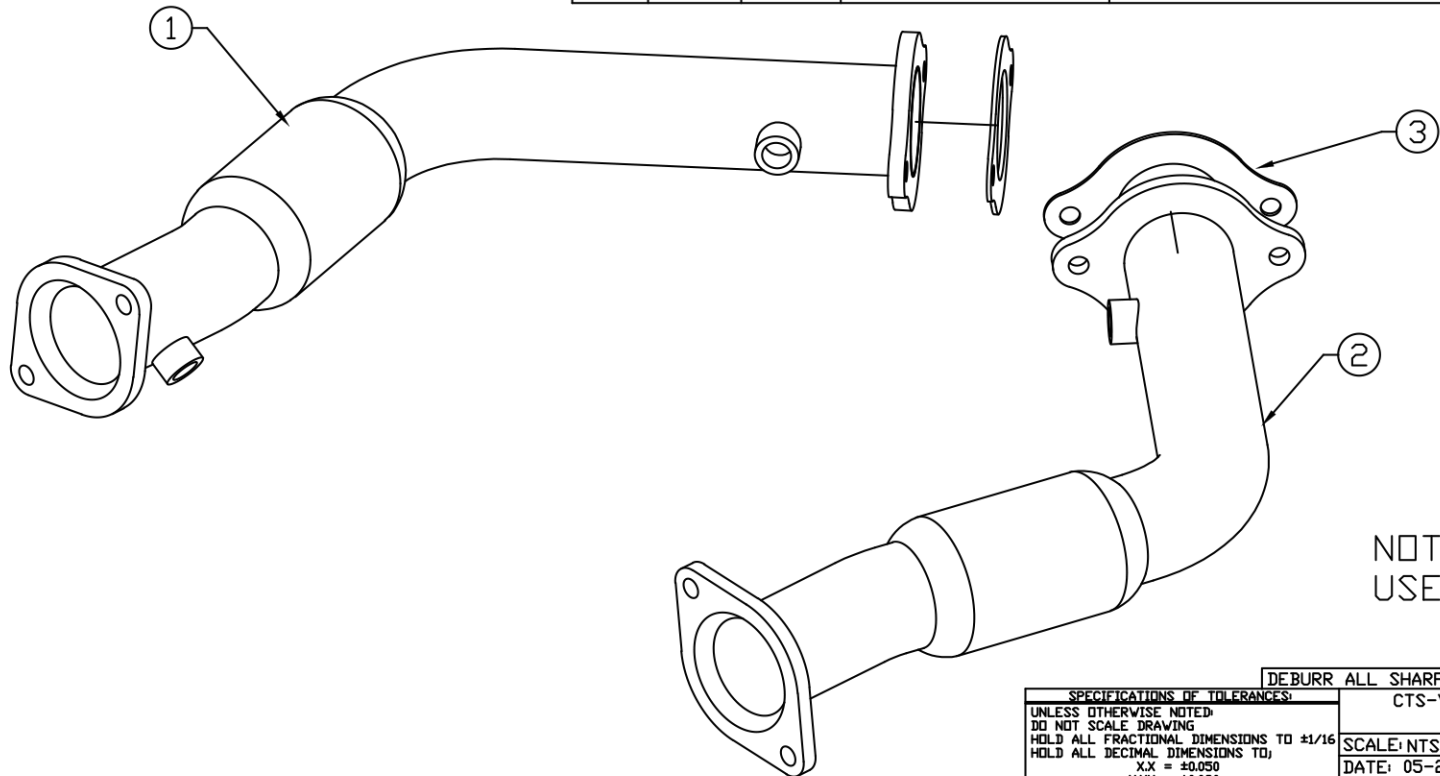

NOTE: LOWER FLANGE
USES FACTORY DONUT

DEBURR ALL SHARP EDGES REV. DATE E.C.N. NO. BY

SPECIFICATIONS OF TOLERANCES:
 UNLESS OTHERWISE NOTED:
 DO NOT SCALE DRAWING
 HOLD ALL FRACTIONAL DIMENSIONS TO $\pm 1/16$
 HOLD ALL DECIMAL DIMENSIONS TO:
 X.X = ± 0.050
 X.XX = ± 0.030
 X.XXX = ± 0.010

CTS-V TEST CAT PIPES 09- SEDAN/COUP

SCALE: NTS	DWN: AWL
DATE: 05-27-16	SHT: 1 OF 1
APPROVAL DATE:	APPROVED BY:

UNAUTHORIZED USE, REPRODUCTION OR
 MANUFACTURE IN WHOLE OR IN PART
 IS PROHIBITED. DRAWING, DESIGN AND
 OTHER DISCLOSURES ARE PROPERTY OF

Billy Boat Performance Exhaust

UNIT(S) INCH	JOB NUMBER:	DRAWING NO. FDDM0336
-----------------	-------------	-------------------------