

BILL OF MATERIALS

ITEM	QTY.	U/M	PACKING	ISP	INT	DESCRIPTION
1	1	EA				DRIVER SIDE MUFFLER SECTION
2	1	EA				PASSENGER SIDE MUFFLER SECTION
3	2	EA				5/15-18 x 3/4" BOLT
4	2	EA				5/16-18 FLANGE NUT
5						
6						
7						
8						

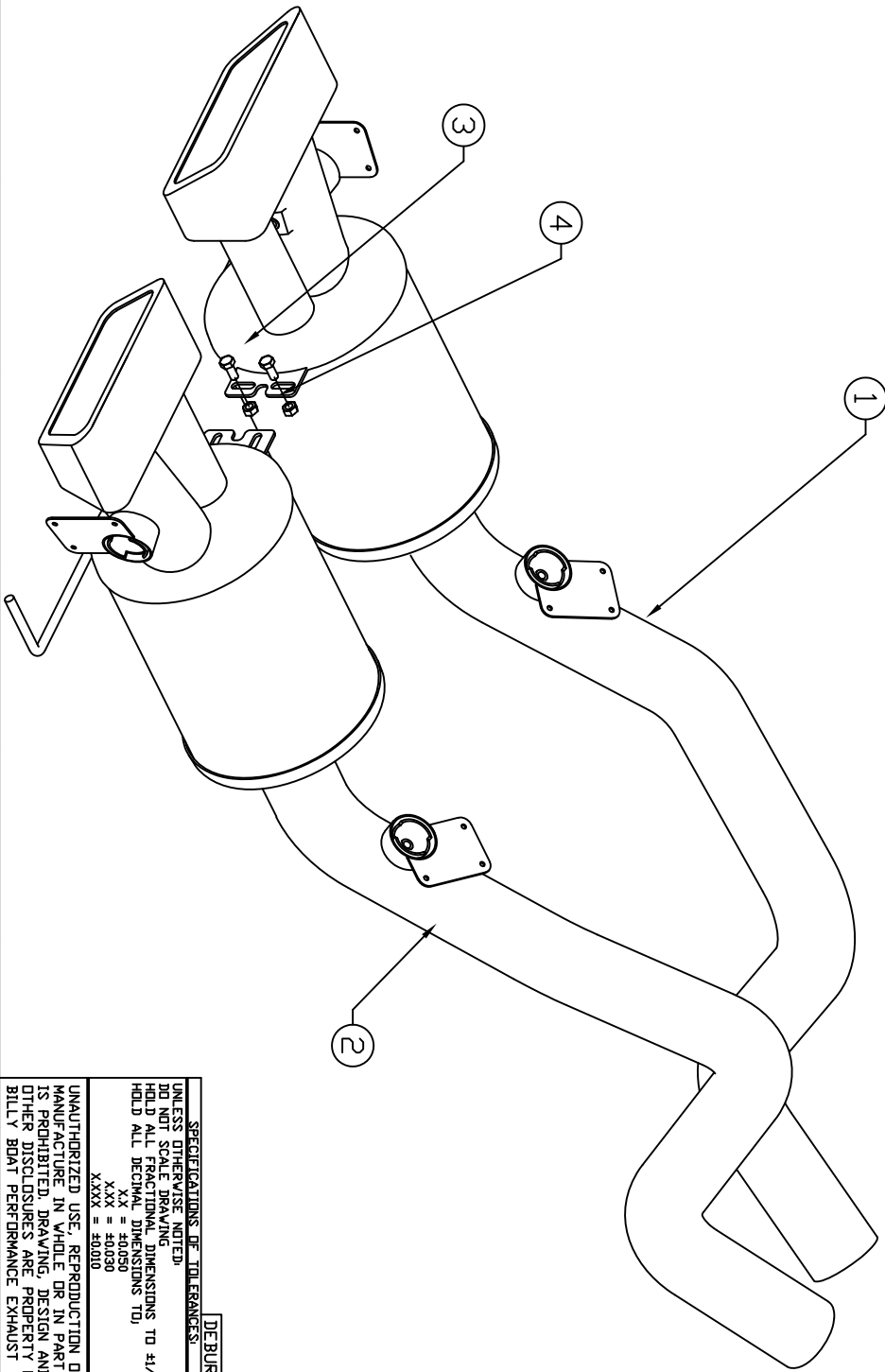

UNLESS OTHERWISE NOTED:
 DO NOT SCALE DRAWING
 HOLD ALL FRACTIONAL DIMENSIONS TO $\pm 1/16$
 HOLD ALL DECIMAL DIMENSIONS TO $\pm .0050$
 X.X = $\pm .0050$
 XXX = $\pm .0010$
 XXXX = $\pm .0001$

DEBURR ALL SHARP EDGES | REV. DATE EC.N. NO. BY

C7 GEN 3 FUSION SPEEDWAY

SCALE: INCHES
 DATE: 06-16-16
 APPROVAL DATE: APPROVED BY: DWN: AVL
 SHT: 1 OF 1

Billy Boat Performance Exhaust

UNIT(S) INCH JOB NUMBER: DRAWING NO. FCDR0667